

VENTANA LE

2016 DIESEL MOTOR COACH



WHEN YOU KNOW THE DIFFERENCE SM



VENTANA
LT

404



VENTANA LE

DIESEL POWER. ZERO COMPROMISE.

Freightliner® XCR chassis with 360 HP Cummins® ISB diesel engine on all 40' floor plans

Completely redesigned sculpted front and rear caps with stainless steel trim

Class-exclusive Feature Ceiling eliminates exposed vents without disrupting airflow

Standard Comfort Drive™ Steering System



WHEN YOU KNOW THE DIFFERENCE SM



KEVIN BOGAN

Vp Of Manufacturing, Newmar Corporation

“As VP of Manufacturing, I oversee individuals who have spent an average of 12 years with Newmar. This level of experience is critical to maintaining the degree of quality required for a product to don the Newmar badge. Every Newmar coach is built one at a time, undergoing well over 1,000 quality inspections while moving through our assembly line. After a unit is completed, it then moves on to what we call the “Customer Quality Inspection.” When we implemented the CQI process, we doubled the amount of time spent performing a final inspection on each coach. Why? It’s simple: Because our customers deserve the best.”

THERE’S NOTHING ENTRY-LEVEL ABOUT IT



Save for its incredibly affordable price, the 2016 Ventana LE is far from the cut-rate coaches that sacrifice features and quality in an effort to appeal to first-time diesel buyers. In fact, Ventana LE continues to represent the industry’s best diesel-powered value, delivering the kind of standard amenities and unparalleled craftsmanship RV enthusiasts have come to expect from Newmar.

To start, every 2016 Ventana LE is supported by Newmar’s latest engineering breakthrough – the all-new STAR Foundation, which adds strength and durability to an already stout Freightliner® chassis. Showcasing reimagined styling both inside and out, Ventana LE touts taller, stainless-steel accented front and rear caps. A new tight-seal front entry door with full-length hinge delivers a quieter ride while a refreshed instrument panel comes equipped with a custom-tuned, 6-speaker JBL® premium cockpit audio system.



Ventana LE with Quad Slide-Outs



VENTANA LE

DIESEL POWER. ZERO COMPROMISE.

Freightliner® XCR chassis with 360 HP Cummins® ISB diesel engine on all 40' floor plans

Completely redesigned sculpted front and rear caps with stainless steel trim

Class-exclusive Feature Ceiling eliminates exposed vents without disrupting airflow

Standard Comfort Drive™ Steering System



WHEN YOU KNOW THE DIFFERENCE SM



Mirage Décor with Full-Tile Flooring - Floor Plan 4044

INCREDIBLE LOOKS. IRRESISTIBLE LUXURY.

From the moment you step inside the 2016 Ventana LE, you know you're in a Newmar. An all-new Mirage décor pairs with an upscale patterned backsplash and solid-surface countertops throughout, setting a stylish tone that is further elevated by handcrafted Sienna Maple Glazed cabinetry.

Designed to encourage rest and relaxation, Ventana LE offers a plush recliner and roomy 87" Flexsteel® Deluxe leather jackknife sofa that delivers an ideal view of the VIZIO® LED TV with Televator.

**Exact features and configuration specific to floor plan 4044*



Sienna Maple Glazed Cabinetry with Solid-Surface Countertops

REST EASY. SLEEP SOUNDLY.

Choose the diesel-powered Ventana LE, and not only are you free to explore the world in all of its glory, you're able to enjoy all of the comforts that come with owning a Newmar. Comforts like a King bed* with a smooth-top mattress, quilted bedspread, bed scarf and accent pillow.

Of course, deluxe sleeping quarters would not be complete without quality amenities like overhead cabinetry and a full wardrobe with room for an available stacked washer and dryer.** Once your day reaches its final conclusion, a standard LED TV with DVD player makes it easy to lie back and unwind.

*King bed standard with select floor plans

**Full wardrobe standard with select floor plans



A SWEET ESCAPE

When your master bathroom is furnished with an under-mounted his and hers stainless steel sink, solid-surface countertops and a glass-door shower with skylight, every day is an opportunity to treat yourself. Just steps away, a mid-cabin half-bath* with vessel sink and oversized mirror makes it easy to accommodate friends and family.

**Mid-cabin half-bath available with select floor plans*



Mid-Cabin Half-Bath with Vessel Sink







DESIGNED FOR ADVENTURE. ENGINEERED FOR LIFE.

Driven by a heavy-duty Freightliner® chassis, the 2016 Ventana LE is more than ready for the road ahead. Ventana LE features Newmar's all-new STAR Foundation, engineered to enhance chassis durability while raising exterior storage compartments by 2", thus increasing space while providing easier access.

When it comes to looks, the 2016 Ventana LE is at the top of its class. Dressed in the industry-renowned Full-Paint Masterpiece Finish®, Ventana LE comes standard with Carefree® of Colorado power side and entrance door awnings.



EXTERIOR DÉCOR



PEPPERCORN EXTERIOR

INTERIOR DÉCOR



CREPE INTERIOR



MIRAGE INTERIOR

WOOD OPTIONS



ASTORIA GLAZED
MAPLE



SIENNA GLAZED
MAPLE



EMPIRE GLAZED
MAPLE



EVENING EXTERIOR

FLOOR PLANS

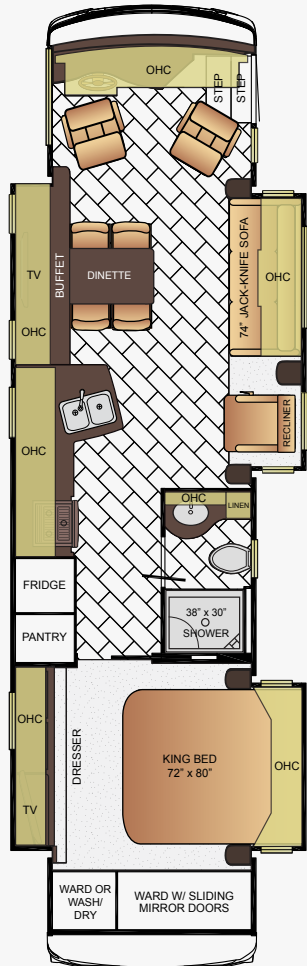

3725

| | |
|---------------------|------------|
| App. Overall Length | 37'8" |
| Width | 101.5" |
| App. Overall Height | 12'10" |
| Interior Width | 95.5" |
| Interior Height | 84" |
| Grey Tank | 65 gal. |
| Sewage Tank | 45 gal. |
| Water Tank | 105 gal. |
| Propane Tank | 32 gal. |
| Furnace | 54,000 btu |

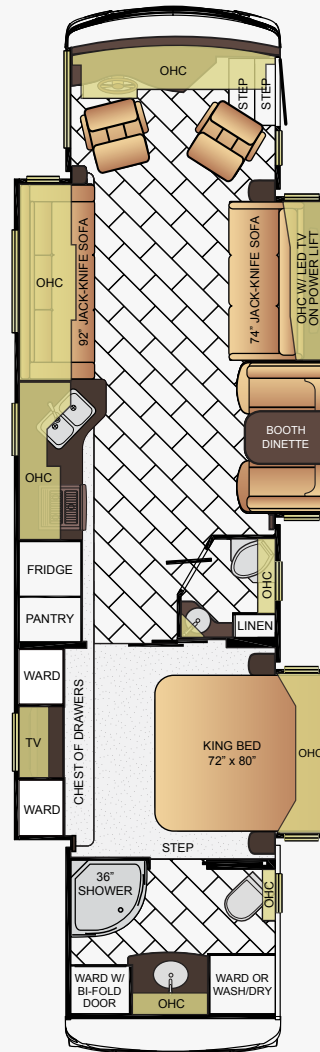

4002

| | |
|---------------------|------------|
| App. Overall Length | 40'10" |
| Width | 101.5" |
| App. Overall Height | 12'10" |
| Interior Width | 95.5" |
| Interior Height | 84" |
| Grey Tank | 65 gal. |
| Sewage Tank | 45 gal. |
| Water Tank | 105 gal. |
| Propane Tank | 32 gal. |
| Furnace | 54,000 btu |

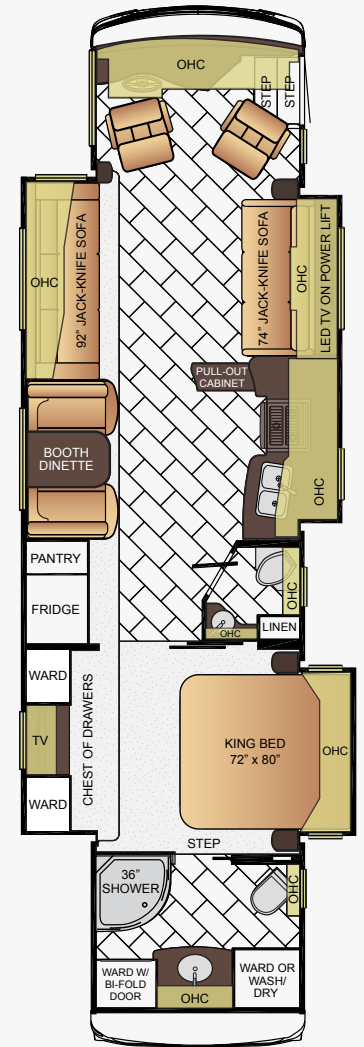

FLOOR PLANS

4037

| | |
|---------------------|------------|
| App. Overall Length | 40'10" |
| Width | 101.5" |
| App. Overall Height | 12'10" |
| Interior Width | 95.5" |
| Interior Height | 84" |
| Grey Tank | 65 gal. |
| Sewage Tank | 45 gal. |
| Water Tank | 105 gal. |
| Propane Tank | 32 gal. |
| Furnace | 54,000 btu |

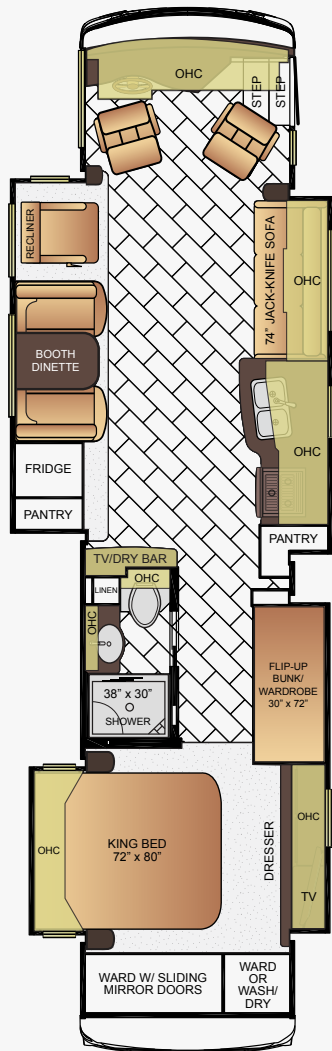

4040

| | |
|---------------------|------------|
| App. Overall Length | 40'10" |
| Width | 101.5" |
| App. Overall Height | 12'10" |
| Interior Width | 95.5" |
| Interior Height | 84" |
| Grey Tank | 65 gal. |
| Sewage Tank | 45 gal. |
| Water Tank | 105 gal. |
| Propane Tank | 32 gal. |
| Furnace | 54,000 btu |

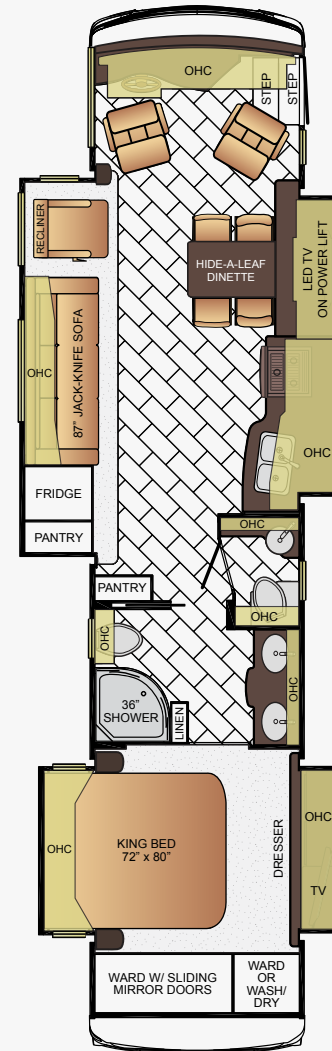

4044

| | |
|---------------------|------------|
| App. Overall Length | 40'10" |
| Width | 101.5" |
| App. Overall Height | 12'10" |
| Interior Width | 95.5" |
| Interior Height | 84" |
| Grey Tank | 65 gal. |
| Sewage Tank | 45 gal. |
| Water Tank | 105 gal. |
| Propane Tank | 32 gal. |
| Furnace | 54,000 btu |

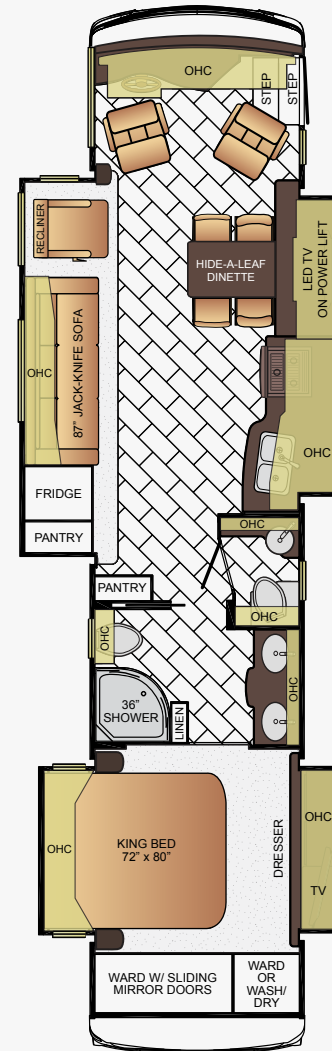

CONSTRUCTION & CHASSIS SPECIFICATIONS

LIKE A FINE HOME, Ventana LE is framed 16 inches on center, allowing the best placements of outlets, switches and other components. Newmar only uses Sikaflex® elastic adhesive throughout Ventana LE's construction – one of the strongest bonding agents available. It seals against air and water and helps

dampen sound and vibration. Electrical wiring holes in Ventana LE's aluminum frame are ringed with plastic grommets to protect wires from chafing. And Newmar's Total Comfort™ Central Air is two separate, fully ducted systems that distribute cool air and remove warm air.

| Floor Plan | Engine HP | Axle Ratio | Fuel Cap. | Wheel Base | Front GAWR* | Rear GAWR* | GVWR* | GCWR* | App. UVW | App. NCC |
|------------|-----------|------------|-----------|------------|-------------|------------|------------|------------|------------|-----------|
| 3427 | 340 | 4.78 | 100 gal. | 206 | 12,000 lb. | 20,000 lb. | 31,000 lb. | 33,000 lb. | 26,500 lb. | 4,500 lb. |
| 3436 | 340 | 4.78 | 100 gal. | 206 | 12,000 lb. | 20,000 lb. | 31,000 lb. | 33,000 lb. | 26,500 lb. | 4,500 lb. |
| 3709 | 340 | 4.78 | 100 gal. | 240 | 12,000 lb. | 20,000 lb. | 31,000 lb. | 33,000 lb. | 27,300 lb. | 3,700 lb. |
| 3725 | 340 | 4.78 | 100 gal. | 240 | 12,000 lb. | 20,000 lb. | 31,000 lb. | 33,000 lb. | 27,300 lb. | 3,700 lb. |
| 4002 | 360 | 4.78 | 100 gal. | 276 | 12,400 lb. | 24,000 lb. | 36,400 lb. | 41,400 lb. | 29,700 lb. | 6,700 lb. |
| 4037 | 360 | 4.78 | 100 gal. | 276 | 12,400 lb. | 24,000 lb. | 36,400 lb. | 41,400 lb. | 29,700 lb. | 6,700 lb. |
| 4040 | 360 | 4.78 | 100 gal. | 276 | 12,400 lb. | 24,000 lb. | 36,400 lb. | 41,400 lb. | 29,700 lb. | 6,700 lb. |
| 4044 | 360 | 4.78 | 100 gal. | 276 | 12,400 lb. | 24,000 lb. | 36,400 lb. | 41,400 lb. | 29,700 lb. | 6,700 lb. |

Lengths, heights, widths and dry weights are approximate. Weight will vary based on optional equipment added to the above base weight.

GAWR: Gross Axle Weight Rating is the maximum permissible weight for an axle.

GVWR: Gross Vehicle Weight Rating is the maximum permissible weight for a fully loaded motor coach.

GCWR: Gross Combination Weight Rating is the value specified by the manufacturer of the vehicle as the maximum allowable loaded weight of this motor coach and any towed trailer or towed vehicle.

UVW: Unloaded Vehicle Weight is the weight of this motor coach as built at the factory with full fuel, engine oil and coolants. Does not include cargo, fresh water, propane gas or dealer-installed accessories.

NCC: Net Carrying Capacity is the maximum weight of all occupants, including the driver, personal belongings, food, fresh water, wastewater, propane gas, tools, tongue weight of towed vehicle, dealer-installed accessories, etc., that can be carried by the motor coach.

**Specifications supplied by the chassis manufacturer.*

Ventana LE R-Values:
Roof R-Value = 19
Sidewall R-Value = 11
Floor R-Value = 16
Basement R-Value = 4

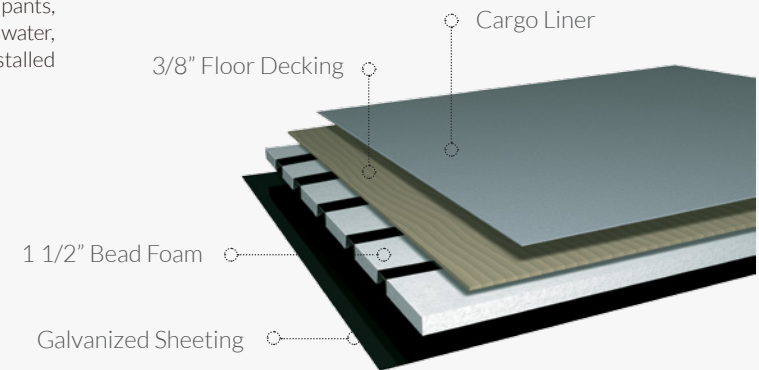



Comfort Drive
STEERING

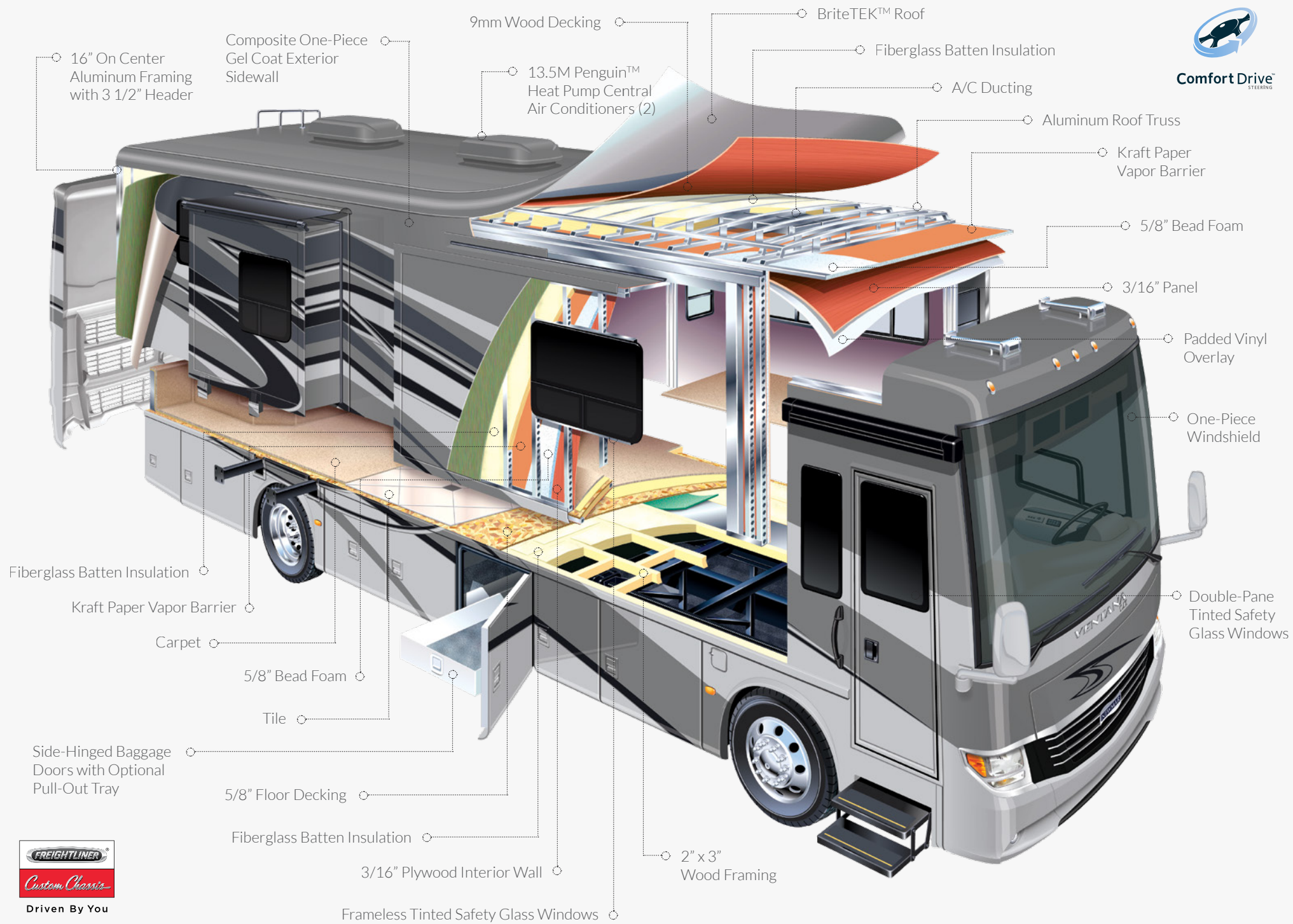

Driven By You



VENTANA LE



CHASSIS FEATURES

Freightliner® XCR Chassis with 340 HP Cummins® ISB Diesel Engine on 34'-37' Floor Plans

Freightliner® XCR Chassis with 360 HP Cummins® ISB Diesel Engine 40' Floor Plans

Chrome Wheel Simulators

Comfort Drive Steering System with Power Column and Adjustable Controls

Cruise Control

Manual Tilt and Telescope Steering Column with VIP Smart Wheel

Recessed Fuel Fills with Crossover to Fill from Either Side

Anti-Lock Braking System



AIR CONDITIONING AND HEATING

Two 13.5M Penguin™ Central Air Conditioners

Propane Furnace with Ducted Heat

Dash Heater and Air Conditioner

Propane Leak Detector

Wall-Mounted Sensors for Heating and Air Conditioning

Driver/Passenger Overhead Dash Fans

OPTIONS

Two 15M Penguin™ Heat Pump Air Conditioners



APPLIANCES

30" Over the Range Microwave

Recessed Three-Burner Range with Oven

Norcold® 10 Cu. Ft. Refrigerator with Black Panel Front

10 gal. Gas/Electric Water Heater with Direct-Spark Ignition

Prep for Two-Piece Washer/Dryer

Countertop-Matching Flush Gas Cooktop Cover

OPTIONS

Norcold® 12 Cf. Four-Door Refrigerator with Icemaker

Frigidaire® 10 Cf. Refrigerator, 2000-Watt Inverter with Six 6-Volt Batteries

Whirlpool® 19.7 Refrigerator, 2000-Watt Pure Sine Inverter & Six 6-Volt Batteries

2000-Watt Modified Sine Inverter with Four 6-Volt Batteries

30" Convection Microwave Oven with Three Burner Cooktop

Whirlpool® Two-Piece Stacked Washer & Dryer

Air Horns



AUDIO, VIDEO AND ACCESSORIES

LED TV and DVD Player in Living and Bedroom Areas. TV Sizes Vary per Floor Plan*

AM/FM/CD In-Dash Radio with JBL® 180-Watt Sound System

Color Rearview Monitor System with Audio

Side-View Cameras Displayed Onto Rearview Monitor Screen

Winegard® Digital Crank Up TV Antenna

Satellite Prep on Roof

TV Jack and 110-Volt Receptor in Door-Side Exterior Storage Compartment

OPTIONS

32" LED TV in Front Overhead

Winegard® Automatic Dome Satellite Dish

Sony® Surround Sound System with Subwoofer

High Definition Component Wiring with Blu-ray/DVD Player

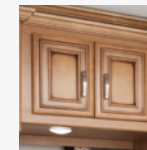

CABINETS AND FURNITURE

Empire Maple Mitered Designer Glazed Cabinet Doors

Concealed Hinges on Cabinet Doors

Drawers with Full Extension Guides

Fixed Pantry Shelves

Polished Solid-Surface Countertop in Kitchen with Stainless Steel Sink and Flush Sink Covers

Solid-Surface Countertops in Bathroom and Bedroom

Flexsteel® Deluxe Leather Sofa and Driver/Passenger Seats

Smooth-Top Mattress

Lifts on Bed Top

Front Seats with 6-Way Power

Passenger Seat Work Station

OPTIONS

Sienna Maple Mitered Designer Glazed Cabinet Doors

Astoria Maple Mitered Designer Glazed Cabinet Doors

Combination Desk with Buffet Dinette Table, 2 Fixed & 2 Folding Chairs

Off-Door Side Hide-a-Bed with Air Mattress

Plush Pillow Top Mattress

Sleep Number® Deluxe Air Mattress

Sleep Number® Premier Air Mattress

Extenda L-Sofa on Off-Door Side

Door-Side Fold and Tumble Sofa with Air Mattress

Power Flip-Up Sofa in Bed Base with Sleep Number® Air Mattress

Power Incline Retracting Bed Base with Sleep Number® Air Mattress

Power Incline Head of Bed with Sleep Number® Air Mattress

FEATURES & OPTIONS

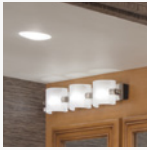

ELECTRICAL FEATURES

- 6.0 kW Cummins Onan® Diesel Quiet Series Generator
- 50-Amp Electrical Service with Flexible Cord and Automatic Transfer Switch
- Four 12-Volt House Batteries on Pullout Tray
- Battery Disconnect Switch for House Battery
- 1200-Watt Inverter
- Emergency Engine Start Switch
- Exterior Security Light on Door Side
- Midship Side Turn Signals
- LED Lights Recessed in Ceiling and Overhead Cabinets
- Manually Operated Hold-To-Run Slideout Switch
- 12-Volt Auxiliary Receptacle on Dashboard
- USB Charger At Dinette & Bedroom Nightstand
- Engine Block Heater
- Cable TV Connection
- Lights in Exterior Storage Compartments
- Interior Courtesy Lights

OPTIONS

- 8.0 Kw Onan® Diesel Quiet Series Generator
- Automatic Generator Start on Low Battery or Temperature Setting



EXTERIOR FEATURES

- Full-Paint Masterpiece Finish™ with Diamond Shield Protection on Front Cap
- Convex Exterior Mirrors with Remote Control and Defrost
- Entrance Door with Automatic Step
- Exterior Storage Compartments with Cargo Liner
- Assist Handle at Entrance Door
- Hydraulic Leveling Jacks
- Stainless Steel Exterior Trim Pieces on Front Cap and Grill Area
- Mud Flaps
- Rear Ladder
- Rear Hitch for Towing Car
- Undercoating

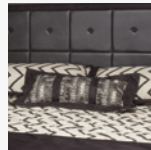

INTERIOR FEATURES

- Dash Panel Color Coordinated ABS
- Interior Assist Handle at Main Entry Door
- Power Stepwell Cover
- Inlaid Six-Panel Design Interior Passage Doors
- Decorative Wall Art
- Padded Vinyl Ceiling
- Day/Night Pleated Window Shades & Lambrequins
- Mini Blinds in Kitchen and Bathroom Windows
- Vinyl Tile Floor in Kitchen, Bathroom and Living Area
- Carpeting in Bedroom and on Slide-out Floors
- MCD® Power Shades at Windshield and Manual Shades on Driver/ Passenger Side Windows
- Quilted Bedspread with Bed Scarf and Accent Pillow
- 10 Bc Fire Extinguisher, Smoke Detector and Carbon Monoxide Detector

OPTIONS

- Laminate Plank Floor in Place of Vinyl Tile
- Bathroom Floor Extended into Bedroom Area
- MCD® Window Shades

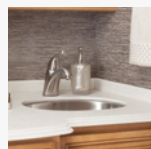

PLUMBING AND BATH FEATURES

- Demand Water System
- Sewage Holding-Tank Rinse
- Water Heater Bypass System
- Dometic® 321 China Bowl Stool or Macerator Stool*
- Systems Monitor Panel
- Fiberglass Shower with Glass Door
- Exterior Shower
- Water Filter for Entire Unit

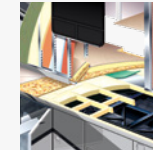

CONSTRUCTION FEATURES

- BriteTEK™ Roof with Walkable Decking
- Gel-Coated Fiberglass Exterior Sidewalls, Front and Rear Caps
- Aluminum-Frame Sidewalls & Roof Construction, 16" on Center
- 5/8" Foam Insulation Laminated in Sidewalls & Ceiling

OPTIONS

- One-Piece Molded Fiberglass Roof
- Polar Pak R-19 Batten Insulation in Roof



WINDOWS, AWNINGS AND VENTS

- One-Piece Tinted Windshield
- Frameless Single-Pane Tinted Safety-Glass Windows
- Power Vent in Kitchen and Bathroom
- Skylight Above Shower
- Carefree® Travel'r™ Power Side and Entrance Door Awnings with Alumaguard
- Slide-out Awning Covers

OPTIONS

- Frameless Double-Pane Tinted Safety Glass Windows
- Fan-Tastic® Vent with Rain Sensor in Kitchen and Bathroom

**Check With Dealership On Floor Plan Availability*



OUR PARTNERS

Where the Finest Names in Quality and Performance are Along for the Ride

To ensure that you experience only the best in comfort, control and unsurpassed convenience in our incomparable family of Luxury Coaches, Newmar partners with the most prestigious names in mobile lifestyle, entertainment and technology. These brands

are leaders in their fields and legends in providing customers with new, unsurpassed levels of quality and reliability. Best-in-class performance from names you can trust. At Newmar, that's our difference. And our promise.



THE MILLER WAY

*Industry-Leading Quality,
From Our Family to Yours*

For the Miller family, RVs are what we build because RVing is what we love. To us, the RV lifestyle is more than our business – it's our passion. Our customers choose Newmar time and time again because they trust in us, our products and our people.

I myself am proud to own a Dutch Star designed, assembled and backed by artisans, engineers and service specialists who represent the best our industry has to offer. Men and women who have spent an average of 13 years as members of the Newmar family. Without them, The Newmar Difference simply wouldn't exist.

Matt Miller
Newmar President, lifelong motor coach enthusiast

VENTANA LE

NEWMAR EXPRESS LIMITED WARRANTY

Every Ventana LE diesel motor coach is backed by Newmar's one-year limited warranty/unlimited miles. Ask your Newmar dealer for details.

LIMITED FIVE-YEAR STRUCTURAL WARRANTY

If any part of your Newmar recreational vehicle superstructure (which is the steel/aluminum structure of the sidewall, roof or frame) fails to perform properly within five years from the date of purchase because of faulty workmanship or material supplied by Newmar, it will be repaired without charge for either parts or labor by Newmar. This structural warranty is available only to the original purchaser and is non-transferable.

Some features in our literature are optional. Colors and finishes are photographic representations. The actual materials may look different. Prices, specifications and floor plans are subject to change at Newmar's discretion, without prior notice or obligation. Please see your dealer for actual samples and specifications.



WHEN YOU KNOW THE DIFFERENCE SM